

LAND OF SONALI SINGHA AND OTHERS.

LAND OF L.R PLOT NO.1563 AND OTHERS.

LAND OF L.R PLOT NO.1570 AND OTHERS.

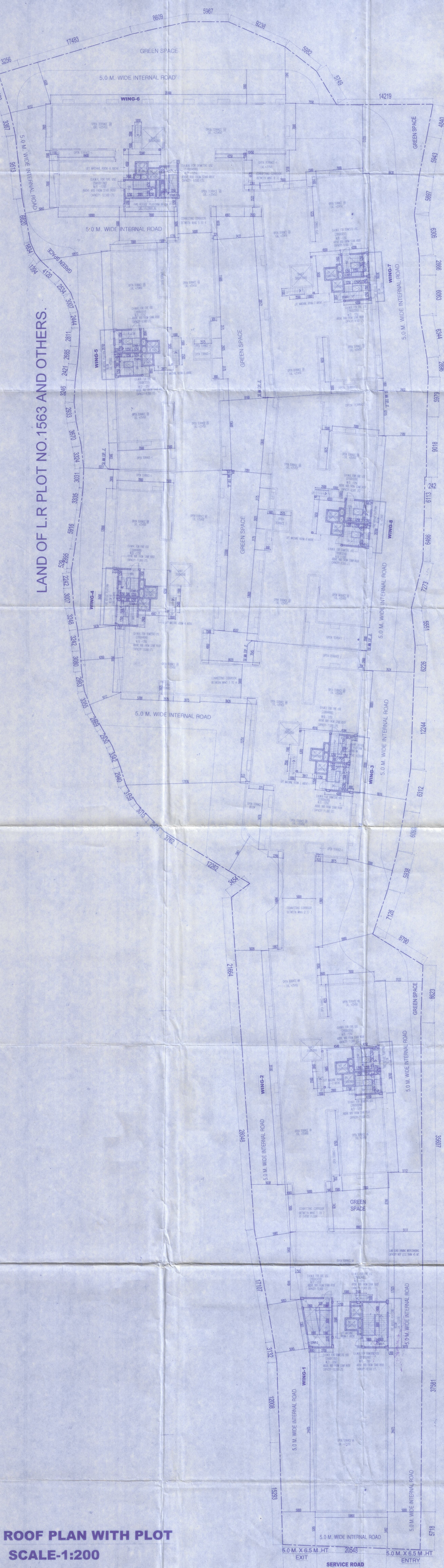

ROOF PLAN WITH PLOT SCALE-1:200

32.0 M. WIDE ROAD

SHEET NO.	04/20	
OWNER DETAILS :-		
MAA POORNAGIRI ESTATES & OTHERS REPRESENTED BY ITS ATTORNEY N B DEVELOPERS - (PARTNER AMAN AGARWAL)		
DECLARATION OF STRUCTURAL ENGINEER		
THE STRUCTURAL DESIGN AND DRAWINGS OF BOTH FOUNDATION AND SUPERSTRUCTURE OF THE BUILDING HAS BEEN MADE BY ME CONSIDERING ALL POSSIBLE LOADS INCLUDING THE SEISMIC LOADS AS PER THE NATIONAL BUILDING CODE OF INDIA AND OTHER RELEVANT CODES, AND CERTIFIED THAT IT IS SAFE AND STABLE IN ALL RESPECTS.		
SIGNATURE OF GEO TECH ENGR.		
SIGNATURE OF STRUCTURAL ENGR.		
DECLARATION OF ARCHITECT :-		
CERTIFIED THAT THE PLAN HAS BEEN DESIGNED AND DRAWN UP STRICTLY ACCORDING TO THE NATIONAL BUILDING CODE (NBC) 2006 & RELEVANT AUTHORITY AND I SHALL BE RESPONSIBLE FOR THE SUPERVISION OF THE BUILDING		
SIGNATURE OF ARCHITECT		
DECLARATION OF OWNER :-		
I DECLARE THAT I SHALL NOT ALTER OR MAKE ANY ADDITION OR ALTERATION TO THIS PLAN. I DECLARE THAT I HAVE COME THROUGH THE RULES AND REGULATIONS OF THE RELEVANT AUTHORITY AND ALSO UNDERTAKE TO ABIDE BY THOSE RULES AND REGULATIONS DURING AND AFTER THE CONSTRUCTION OF THE BUILDING. I MAY APPOINT A LBS/TECHNICAL PERSON FOR SUPERVISION DURING CONSTRUCTION.		
SIGNATURE OF OWNER		
NB DEVELOPERS (PARTNER) AS CONSTITUTED ATTORNEY OF		
1. SAGAR DHAMEJA		
2. SUNIL KR. DHAMEJA		
3. SUNIL SHRE DAS		
4. ANIL K. KANTANI		
5. G. R. C. FRAMED STRUCTURE		
6. FOR SPECIFICATION OF MATERIALS & WORKMANSHIP N.B.C. TO BE FOLLOWED.		
7. OPEN TERRACE WITH LIME TERRACING OF RATIO 2:2:7.		
8. DAMP PROOF COURSE TO BE PROVIDED WITH P.C.C. (1:2:4).		
PROJECT		
PROPOSED PLAN OF (WING-1) 5+VI STORED COMMERCIAL BUILDING, (WING-2) 5+VII STORED RESIDENTIAL BUILDING, (WING-3 TO WING-8) 8+0+VII STORED RESIDENTIAL OF MAA POORNAGIRI ESTATES & OTHERS AT MOUZA, BARAMOHAN SINGH, R.S. PLOT NO.- 757, 758, 759, R.S. KHATIAN NO.- 215, 216, 219, L.R. PLOT NO.- 1558, 1559, 1567, 1568, L.R. KHATIAN NO.- 10970, 10972, 10973, 10974, 10975, 10976, 10977, 10978, 11002, 10028, J.L. NO.- 71, P.S.-MATTIGARA, PARGANA - PATHARGHATA, DIST. DARJEELING, PIN - 734011		
LUCC APPROVED NUMBER - 6365SJD		
LAND SCHEDULE		
MOUZA	- BARAMOHAN SINGH	
R.S. PLOT NO.	- 757, 758, 759	
R.S. KHATIAN NO.	- 215, 216, 219, 353	
L.R. PLOT NO.	- 1558, 1559, 1567, 1568	
L.R. KHATIAN NO.	- 10970, 10972, 10973, 10974, 10975, 10976, 10977, 10978, 11002, 10028	
J.L. NO.	- 71	
P.S.	- MATTIGARA	
PARGANA	- PATHARGHATA	
DIST.	- DARJEELING	
PIN	- 734011	
TITLE		
ROOF PLAN WITH PLOT		
SCALE - 1:100	DRAWN BY: SOMA	CHECKED BY: SOMA
DATE - 09.07.2021		
ARCHITECT		
58 Chittagong Road, 4th Floor, The Elys Heights, KPM-8701046, P. 033 2338 2294 E: massvoid@gmail.com, W: www.massvoid.com		